

Comprehensive Smoke & Fire Protection Solutions

UL Listed,
Labeled
& Classified



U.S. SMOKE & FIRE®

The **U.S. Smoke & Fire®** system provides a concealed, elegant, effective means of achieving smoke and fire protection for a variety of applications: multi-level atria smoke control, opening protectives, rating glass, area separation, cross corridor application for fire barriers and smoke barriers. Our technology pioneered with Underwriter's Laboratories integrates market-leading features, cost-effective, and flexible solution to smoke and fire containment. The fire protective smoke curtains maintain the smoke 6 feet above the finished floor in compliance with IBC 909, providing enough time for a safe egress. Our light-weight curtain material is UL Classified, as is our releasing device under UL 864, allowing it to tie into a building's fire alarm panel.

Under normal conditions the **U.S. Smoke & Fire Protection System** is concealed in the ceiling. Upon a signal from the fire alarm system the system descends by gravity. Deployment is gravity fail safe and does not require power to descend. Side guides mounted within the wall frame are utilized to guide the curtains descent and provide a UL S label for smoke and or fire barrier applications. Our system integrates with all existing fire alarm systems and smoke/IR detectors.



Model SD240A



Model SD60

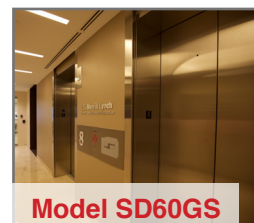

Model SD60GS

U.S. Smoke& Fire Curtain Deployed Around Atrium

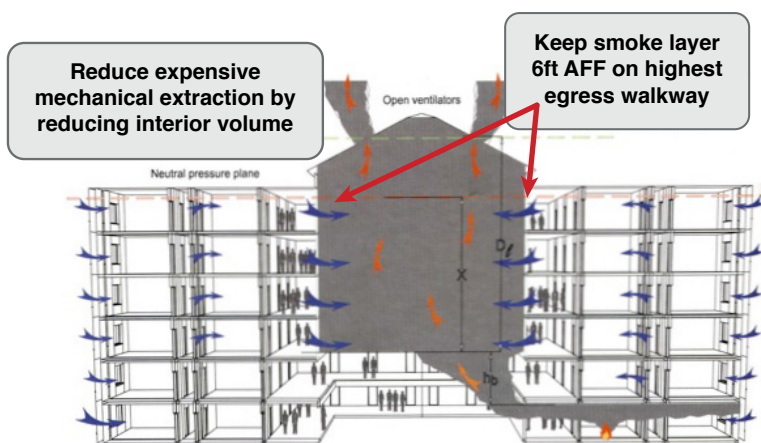

Protect atriums from smoke spread, and reduce dependence on extraction systems with our fail safe design. Open up your atrium to light and air without sacrificing safety. Hidden protection you always know is there.

U.S. Smoke& Fire Curtain Features

- Smoke & Fire Protection in One Solution: UL 10D Listed, Labeled & Classified up to 3 hr. Fire Rating
- UL 10B, UL 10C, UL 263 Time Temp Curves, UL 864, UL 1784
- ICC ESR 3322 Report
- 2-stage Descent Available, Delayed Descent
- Pass Through Slot Egress
- Rewind Switches
- Lightweight, easy to lift by hand
- Installs Compactly Overhead—as little as 6" of ceiling headroom
- Design freedom, LEED Credit
- Available in sizes up to 300 feet in length and 42 feet for the curtain drop height
- Low Life Cycle Cost
- Fail Safe Design

www.ussmokeandfirecurtain.com
www.ussmokeandfire.com
888.917.8777



Comprehensive Smoke & Fire Protection Solutions



UL Listed,
Labeled
& Classified



U.S. SMOKE & FIRE®

Model SD60

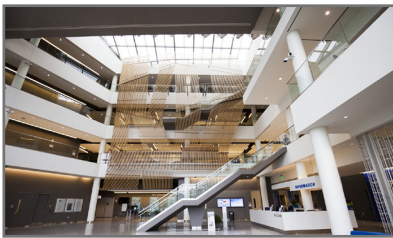

ATRIUM smoke curtains can reduce a building's dedicated mechanical extraction, which is the traditional means of smoke control in the United States. Mechanical extraction is an expensive solution over the life cycle of the building, as it requires significant generator back up power. Utilizing curtains to compartmentalize and separate the atrium from the rest of the building can reduce the amount of dedicated mechanical extraction significantly; reducing the building's overall cost.



SMOKE & FIRE BARRIER applications can be used for elevator or area separation applications. Utilizing side guides recessed in the wall frame, these curtains come standard with UL S label for smoke and draft assemblies and come in 1, 2 or 3 hour fire ratings. Our UL S label testing report reveals that our product's performance beats the testing criteria for the listing by six fold! Emergency curtain up buttons, installed in the hallway or wall jamb, are powered by our internal battery system.

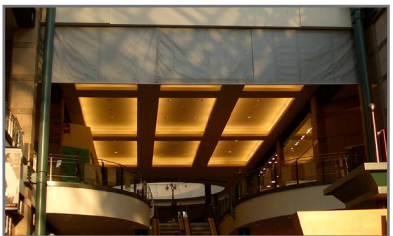

SMOKE RESERVOIRS can be formed using our automatic curtains. The curtains will descend to a pre-determined height. This height will be greater than the calculated smoke layer produced from the surrounding fire load.

The depth of the reservoir is also based upon either how much smoke can be removed from the area using the extraction system or how long the smoke layer will remain buoyant. The drop height of the curtains does not prevent escape from area.



AREA SEPARATION & MONUMENTAL STAIRWAYS can form a direct means for hot smoke to enter floors above. For the project shown on the right, automatic smoke curtains were installed on the three open sides to the escalator.

Upon receipt of a fire signal, the curtain along the length of the opening will drop to full height; the two end curtains will descend part way until a brake is energized in the motor. The partial drop will prevent the hot smoke entering the floor above and also allow egress. Rewind Switches, pass through egress slots available.

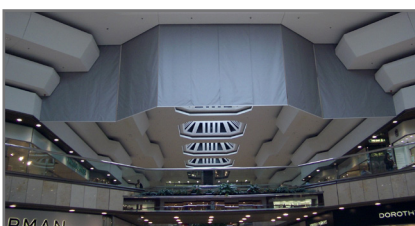

www.ussmokeandfirecurtain.com
www.ussmokeandfire.com
888.917.8777

